

TECHNICAL SPECIFICATIONS

DMT1250

12V Series
DC - DC 50A Charger

Alternator or
PV Input



Product features

- Dual input: MPPT Solar input and Auxiliary input.
- Multi-stage charging ensures batteries are charged to battery manufacturer's recommendations.
- Microprocessor controlled charging algorithm (Bulk, Absorption, Float) for Gel, Program, AGM Lithium, and Flooded batteries with equalization.
- MPPT solar regulator provides maximum power from solar panels to battery.
- Silent Mode for quiet operation.

Product dimensions

Width: 9.5", Length: 6.7", Height: 2.9" (243.2mm x 170mm x 72.5mm)

Specifications subject to change without notice.

kisaepower.com

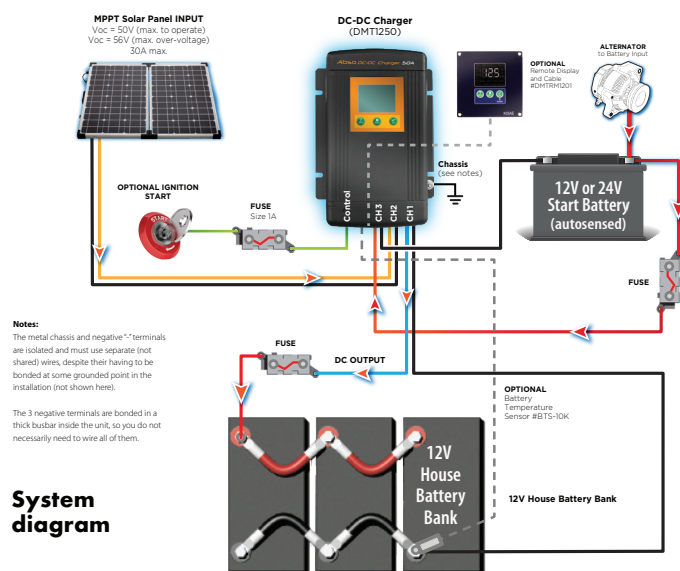

System diagram

Terminal Connections



KISAE has provided this drawing as a guide only. Installers using it must ensure the system is installed to meet local code requirements.
Please refer to the Owner's Manual for proper fuse protection and wire sizing.

DMT1250 12V Series DC - DC 50A Charger

DC Controller Output

Output Current (Maximum)	50A
Output Voltage Range:	
Charge	13.5 - 15.5V
Float	13.0 - 13.8V
Equalize	15.5V
Charging Control	5 Stages (Test/Bulk/Absorption/Float/Recharge)
DC Output Bank	One
Selectable Battery Type	Gel, Flooded (with Eq.), AGM, Lithium, Program,
Parasitic Current	< 200 uA
Efficiency	> 90%

DC Input (Battery/Alternator)

DC Input Range	10.5 - 32Vdc
DC Input Nominal Operation	12.8V for 12V charging system
	25.6V for 24V charging system
Engine Start Control: ON	DC input from Battery/Alternator
Engine Start Control: OFF	DC Input from PV input (if applicable)
Maximum Input Current	50A

DC Input (PV Input)

DC Input Range	14.5/ 14* - 50 Vdc (*Cut-in/Cut-out)
Max. PV Open Circuit Voltage (Voc)	50 Vdc
30A Max.	
DC Input Nominal Operation:	17.5Vdc for 12V PV panels connected in parallel
	35Vdc for 12V PV panels connected in series
MPPT Tracking Efficiency	> 98%

DC Output Protection and Features

Reverse Battery	Yes (shutdown), Auto Reset
DC Output Short Circuit	Yes (shutdown), Auto Reset
Over Charge	Yes (shutdown), Auto Reset
Over temperature	Yes (de-rated and shutdown)
Cooling	Force Air Ventilation
Temperature Setting	Hot, Normal, Cold (no sensor connected)
Battery Temperature Sensor Port	RJ12 (optional Battery Temperature Sensor use)
Digital Display Port	RJ12 (optional Display Panel use)

Display Panel

Display	LCD display with back lighting
---------	--------------------------------

Display Information

Icons	For availability and activation status of ports and operating modes.
Messages and Values	For voltages, output current, errors, alarms, and setting menu & parameters

Enclosure

DC Input Connection	Hardwire
DC Output Connection	Hardwire

Size

Dimensions (W x L x H)	9.5" x 6.7" x 2.9" (243.2mm x 170mm x 72.5mm)
Net Weight	4.1 lbs. / 1.85 Kg

Accessories (optional)

Remote Panel	DMTRM1201 (For viewing unit status, adjusting settings)
Battery Temperature Sensor	BTS-10K (For battery charging voltage adjustment)

Regulatory Compliance

Markings	CE
Conformance OK	LVD, EMC
EMI/EMC OK	CE, EMC

Schematic Drawings

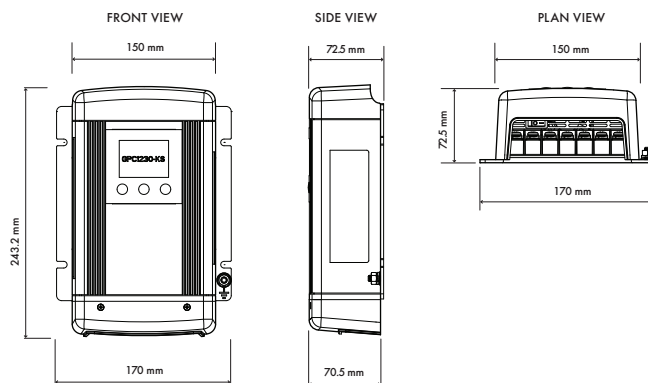

Standard warranty

2 year warranty



This product carries a cETLus safety certification which complies with the Regulatory safety standards for North America.

All specifications subject to change without notice.
Copyright © 2022 Kisa Technology Inc. All Rights Reserved under UCC 1-308 without prejudice.

To learn more about this and other fine Kisa products please contact:

info@kisaetechnology.com

kisaepower.com

Distributor: